

2', 3', or 4'
1 or 2 Lamp
T8, T5, T5HO, or CFTT5

APPLICATION

- Surface wall-mounted direct/indirect luminaire.
- Suitable for individual or continuous row mounting.
- Continuous rows can be installed on the wall at the ceiling to provide an integral cove appearance.
- Also suitable for use lower on the wall as a sconce or in continuous rows.
- ADA approved for applications requiring lower mounting heights.

CONSTRUCTION/FINISH

- No visible hardware.
- Swing down lamp cover for easy relamping.
- Multi-stage phosphate treated for maximum corrosion resistance and finish coat is baked matte white enamel.
- Easy ballast access through removable reflector.
- Die-cast decorative aluminum end caps are held on by magnets to provide secure retention and easy, toolless installation or removal.

ELECTRICAL

- UL listed for damp locations.
- Class P, HPF ballasts comply with © Federal Ballast Law (public law 100-357, 1988.)

- Self-contained low-profile emergency power pack can be incorporated. UL listed for dry locations.
- Modular wiring may be incorporated for continuous row applications.
- Electronic ballast standard for maximum efficiency.

ENCLOSURES

- Micro-perforated lamp shield provides soft awareness to lamp source.
- White overlay on inside of lamp cover conceals lamp image.
- Solid top cover (no upright) is standard.
- Uplight option w/lens available for lower mounting heights, not recommended for mounting near ceiling.
- End caps are **required**. They can be factory-installed (-DEK option) for individual mounting or shipped separately for row applications (cat. # **AVW-DEK**).*
- For continuous row applications, order one joiner (cat. # **AVW-IJ**) for each junction of two luminaires.

ACCESSORIES

- **AVW-DEK** - end caps (pair)
- **AVW-IJ** - in-line joiner

CATALOG NUMBER

AVW	[]	[]	-	[]	-	[]	-	[]
FAMILY AVW- Ariosso Wall	LAMP TYPE/WATTAGE			VOLTAGE			*Standard luminaire does not include end caps. Either -DEK option or AVW-DEK accessory is required.	
	14 - 14wT5 (22") 17 - 17wT8 (24") 24HO - 24wT5HO (22") 21 - 21wT5 (34") 25 - 25wT8 (36") 39HO - 39wT5HO (34") 28 - 28wT5 (46") 32 - 32wT8 (48") 54HO - 54wT5HO (46") CF40 - 40wTT5 (24") CF50 - 50wTT5 (24") CF55 - 55wTT5 (24")			120 277 347 UNV - Universal voltage, 120-277 volt				
	NO. OF LAMPS/ CROSS SECTION (not included) 1 2 (except CF)			SHIELDING PMW - Perforated Metal with White Overlay			OPTIONS	
							CM - Canadian Market DEK - Decorative ends factory installed* LENS - Uplight w/Lens CC - Custom color (RAL number or color chip required)	

NOTES:

- With generic Electronic Ballasts (Brand selected by Day-Brite)
Suffix Catalog # with- **Ballast Quantity** - / - **EB** **Lamps Per Ballast.**

Example: -1/2-EB = One 2 Lamp Electronic Ballast.

DIMENSIONS

	DIM "A" w/DEK end caps	without end caps
2' model	25-1/2" (648mm)	24" (610mm)
3' model	37-1/2" (953mm)	36" (914mm)
4' model	49-1/2" (1257mm)	48" (1219mm)

1 Lamp Standard

2 Lamp w/Lens Option

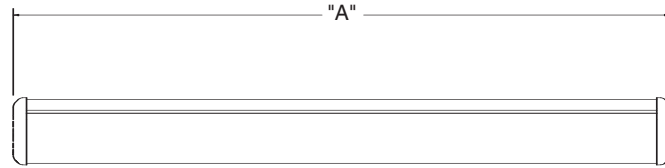
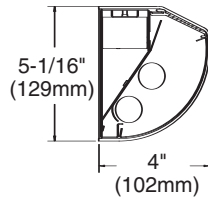
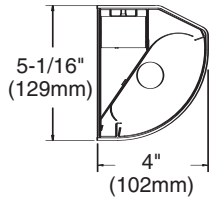

4' models

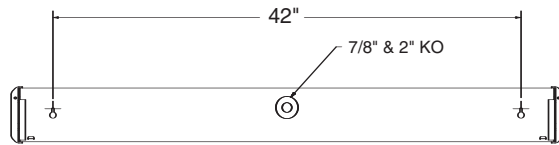

3' models

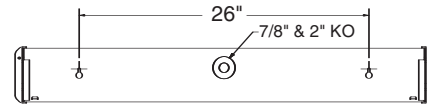

2' models

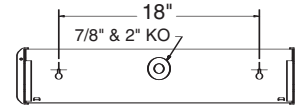

PHOTOMETRIC DATA

CATALOG # AVW232-PMW-1/2-EB
TEST #24706 S/MH = 2.0

LAMPS = F32T8
BALLAST = ELECTRONIC

INPUT WATTS = 56
BALLAST FACTOR = .88

LER = 31

COMPARATIVE YEARLY LIGHTING ENERGY COST PER 1000 LUMENS = \$7.74 BASED ON 3000 HRS. AND \$.08 PER KWH.

FIXTURE EFFICIENCY = 34.7%

CANDLEPOWER			
Angle	End	45	Cross
0	493	493	493
5	483	517	544
15	466	553	616
25	429	577	682
35	370	580	717
45	293	555	720
55	196	508	696
65	98	439	641
75	24	346	563
85	2	255	472
95	0	181	382
105	0	121	294
115	0	69	208
125	0	36	134
135	1	17	75
145	1	6	33
155	2	0	6
165	2	2	2
175	2	2	2

MAINTAINED ILLUMINATION TABLE- Square Feet/Fixture*

- 80-50-20 Reflectances (Ceiling-Wall-Floor)
- LLF = 0.75 2850 Lumens/Lamp very clean
- Room width divided by room height = 5 or more, 2 or 1

Fixture Size & # of Lamps	Room Width Room Height =	Approx. Area (sq. ft.) per Fixture				
		10 ft-c	30 ft-c	50 ft-c	70 ft-c	100 ft-c
4'	5	145	48	-	-	-
2 Lamp	2	95	32	-	-	-
T8	1	69	-	-	-	-

*Observe Fixture S/MH Requirements for Specific Applications

AVERAGE LUMINANCE CD/SQ.M WITH 2850 LUMEN LAMPS			
ANGLE	END	45°	CROSS
45	3868	1340	2973
55	3837	926	2452
65	3745	560	1664
75	3616	305	665
85	3482	659	165

Room Size	TYPICAL V.C.P.'s Mounting Height			
	Lengthwise	Crosswise	8.5	10
30x30	64	68	52	59
40x40	61	64	50	54
60x30	65	68	58	63
60x60	59	61	46	49
100x100	57	58	44	46

COEFFICIENT OF UTILIZATION

pfc pcc pw RCR	20			70			50		
	70	50	30	70	50	30	70	50	30
0	40	40	40	39	39	39	35	35	35
1	35	34	32	34	33	30	29	28	28
2	32	28	26	30	28	26	26	23	23
3	28	25	22	28	23	22	23	20	20
4	27	22	19	25	20	17	20	17	17
5	23	20	16	23	19	16	17	14	14
6	23	17	14	22	17	14	16	13	13
7	20	16	13	20	16	13	14	11	11
8	19	14	11	19	14	11	13	11	11
9	17	13	10	17	13	10	11	10	10
10	17	11	8	16	11	8	11	8	8

LIGHT DISTRIBUTION

DEGREES	LUMENS	% LAMP	% FIXTURE
0-30	390	6.8	19.7
0-40	647	11.3	32.7
0-60	1185	20.8	59.9
0-90	1719	30.2	87.0
90-180	258	4.5	13.0
0-180	1976	34.7	100.0

LLF = .75 LLF = LIGHT LOSS FACTOR LLF = LDD X LLD X BF LDD = VERY CLEAN 0.94 CLEAN 0.90
LLD = 0.91 @ 40% RATED LAMP LIFE BF = .88 ELECTRONIC BALLAST & T8 LAMP (RELAMP AT 70% LAMP LIFE)

PHOTOMETRIC DATA

CATALOG # AVW232-PMW-1/2-EB-LENS
TEST #24704 S/MH = 2.0

LAMPS = F32T8
BALLAST = ELECTRONIC

INPUT WATTS = 59
BALLAST FACTOR = .88

LER = 44

COMPARATIVE YEARLY LIGHTING ENERGY COST PER 1000 LUMENS = \$5.45 BASED ON 3000 HRS. AND \$.08 PER KWH.

FIXTURE EFFICIENCY = 51.4%

CANDLEPOWER			
Angle	End	45	Cross
0	387	387	387
5	380	404	424
15	363	431	475
25	333	448	523
35	285	453	555
45	222	446	560
55	149	412	558
65	68	365	539
75	15	318	523
85	1	291	487
95	2	303	476
105	27	374	511
115	73	442	602
125	152	489	709
135	239	506	725
145	308	514	695
155	356	498	626
165	387	459	542
175	401	413	459

MAINTAINED ILLUMINATION TABLE- Square Feet/Fixture*

- 80-50-20 Reflectances (Ceiling-Wall-Floor)
- LLF = 0.75 2850 Lumens/Lamp very clean
- Room width divided by room height = 5 or more, 2 or 1

Fixture Size & # of Lamps	Room Width Room Height =	Approx. Area (sq. ft.) per Fixture				
		10 ft-c	30 ft-c	50 ft-c	70 ft-c	100 ft-c
4'	5	-	66	40	-	-
2 Lamp	2	132	44	-	-	-
T8 w/uplight	1	94	31	-	-	-

*Observe Fixture S/MH Requirements for Specific Applications

AVERAGE LUMINANCE CD/SQ.M WITH 2850 LUMEN LAMPS			
ANGLE	END	45°	CROSS
45	3009	1096	2253
55	3076	788	1864
65	3149	509	1155
75	3359	305	416
85	3593	412	82

Room Size	TYPICAL V.C.P.'s Mounting Height			
	Lengthwise	Crosswise	8.5	10
30x30	74	79	62	69
40x40	69	73	56	62
60x30	72	76	65	71
60x60	64	67	51	55
100x100	58	61	47	49

COEFFICIENT OF UTILIZATION

pfc pcc pw RCR	20			70			50		
	70	50	30	70	50	30	70	50	30
0	55	55	55	51	51	51	42	42	42
1	48	46	44	45	42	40	35	34	34
2	44	40	35	40	36	34	30	28	28
3	40	34	30	36	32	28	27	23	23
4	36	30	26	33	28	23	23	20	20
5	34	27	23	30	25	20	20	17	17
6	30	23	20	28	22	17	19	16	16
7	28	22	17	26	20	16	17	14	14
8	26	20	16	23	17	14	16	13	13
9	25	17	14	22	17	13	14	11	11
10	23	17	13	20	14	11	13	10	10

LIGHT DISTRIBUTION

DEGREES	LUMENS	% LAMP	% FIXTURE
0-30	308	5.4	10.5
0-40	510	8.9	17.4
0-60	940	16.5	32.1
0-90	1438	25.2	49.1
90-180	1492	26.2	50.9
0-180	2930	51.4	100.0

LLF = .75 LLF = LIGHT LOSS FACTOR LLF = LDD X LLD X BF LDD = VERY CLEAN 0.94 CLEAN 0.90
LLD = 0.91 @ 40% RATED LAMP LIFE BF = .88 ELECTRONIC BALLAST & T8 LAMP (RELAMP AT 70% LAMP LIFE)